

# VH550 Exploded Parts View

## VH550 VACUUM CANISTER

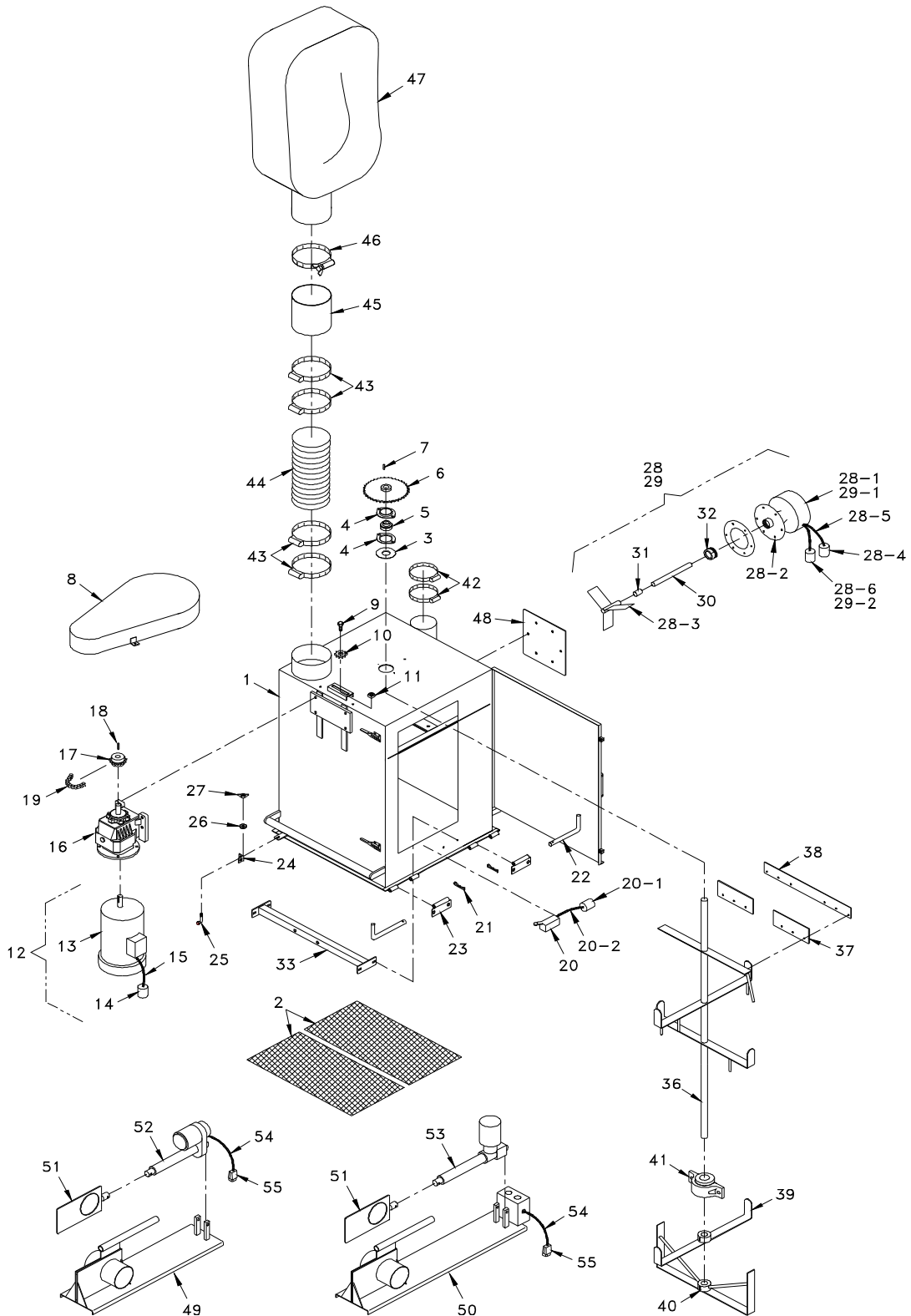

See next page for Parts List.

## VH550 Exploded Parts List

| Item# | Part#           | Description                                  |
|-------|-----------------|--|
| 1     | 200500-1-1-R1   | Hopper, Upper Vacuum                         |
| 2     | 200500-9        | Screen, Aluminum, Vacuum Hopper (2)          |
| 3     | 564             | Seal, Felt, 3 1/4" O.D. x 1"                 |
| 4     | 565             | Housing, Flange, 1", 2-Bolt (2)              |
| 5     | 563             | Bearing Insert, 1"                           |
| 6     | S-40BS40        | Sprocket, #40 40T x 1"                       |
| 7     | 562             | Key 1/4" x 1/4" x 1 1/4"                     |
| 8     | 200500-1-6      | Guard, Vacuum Hopper                         |
| 9     | FSB112          | SB 5/8" x 1 3/4" Shoulder Bolt               |
| 10    | 432             | Sprocket, Idler #40 17T x 5/8"               |
| 11    | 40052           | Nut, 1" x 1/2" (Plated)                      |
| 12    | VH550-CORE-60-1 | Motor Assy, 3/4 H.P., 120V/60 Hz. (U.S.)     |
| 12    | VH550-CORE-50-1 | Motor Assy, 3/4 H.P., 230V/50 Hz. (Overseas) |
| 13    | 511-1A          | Motor, 3/4 H.P., 56 C-Face, 60 Hz (U.S.)     |
| 14    | 1538            | Plug, NEMA#L5-15P (U.S.)                     |
| 15    | 12-3 SJ         | Wire, 12-3 SJ, 70" Long                      |
| 16    | 575GB           | Gearbox, In-Line                             |
| 17    | S-40B15-B       | Sprocket 15T x 1" w/Hub                      |
| 18    | 561             | Key, 1/4" x 1/4" x 1"                        |
| 19    | 109019-8        | #40 Chain, 46" Long                          |
| 20    | 250523-1        | Limit Switch                                 |
| 20-1  | 126-B           | Plug, NEMA# 6-15P                            |
| 20-2  | 18-3 SJ         | Wire, 18-3 SJ, 26" Long                      |
| 21    | 150303          | Pin, Clevis (2)                              |
| 22    | 541             | Hinge Pin (2)                                |
| 23    | 580             | Bracket, Hinge, Hopper Extension (2)         |
| 24    | 581             | Latch Down Bracket (2)                       |
| 25    | 2530-1          | Latch Bolt, 2" Bent (2)                      |
| 26    | FW007           | 5/16" Flat Washer (2)                        |
| 27    | FN013           | 5/16 - 18 Wing Nut (2)                       |
| 28    | VH550-3         | Bin Level Indicator Assy, 60Hz. (U.S.)       |
| 28-1  | 150523-3        | Bin Level Indicator, 120V (U.S.)             |
| 28-2  | 150523-7        | Flange Assy w/Gasket                         |
| 28-3  | 150523-6        | Paddle, Indicator                            |
| 28-4  | 250530-A1-1     | Connector (4579C)                            |
| 28-5  | 18-3 SJ         | Wire, 18-3 SJ 6ft Long (2)                   |
| 28-6  | 434             | Plug, NEMA#L6-15P (U.S.)                     |

## VH550 Exploded Parts List

| Item# | Part#        | Description   |
|-------|--------------|---|
| 29    | VH550-3-50   | Bin Level Indicator Assy, 50hZ. (Overseas)                    |
| 29-1  | 150523-3-230 | Bin Level Indicator, 230V (Overseas)                          |
| 29-2  | 1538         | Plug, NEMA# L5-15P (Overseas)                                 |
| 30    | 150523-4     | Nipple, Pipe 1/4" x 3 1/2"                                    |
| 31    | 150523-5     | Coupling, Pipe 1/4"   |
| 32    | 250527       | Bushing Reducer, 1 1/4" - 1/2" PVC                            |
| 33    | 200500-1-7   | Brace, f/Vertical Agitator                                    |
| 34    | 109078-1-1   | Pin, Clevis, 1/4" x 2 1/4" (3)                                |
| 35    | 109078-1-2   | Pin, Roll, 3/32" x 1/2" (3)                                   |
| 36    | 200500-1-2   | Agitator, Vertical  |
| 37    | 150524-2     | Wiper Strip, Screen, Rhionhyde (2)                            |
| 38    | 150524-3     | Retainer, Bar   |
| 39    | 200500-1-4   | Agitator Tine, w/Hub Top                                      |
| 40    | 200500-1-5   | Agitator Tine, w/Hub Bottom                                   |
| 41    | 1032         | Bearing, 1" P.B.  |
| 42    | 340          | Clamp, Hose, 4" (2)   |
| 43    | 341          | Clamp, Hose, 6" (6)   |
| 44    | H435         | Hose, Flex-Thane, 6", 36" long                                |
| 45    | VH550-5      | Tube, Connector, 6"   |
| 46    | 150522       | Clamp, Hose, 6" w/wingnut                                     |
| 47    | FB250-2      | Bag, Filter   |
| 48    | VH550-4      | Cover, Bin Level, 9" x 9"                                     |
| 49    | VH550-B-2-3  | Mounting Frame, Blastgate (U.S)                               |
| 50    | VH550-B-2-7  | Mounting Frame, Blastgate (Overseas)                          |
| 51    | VH550-B-2-2  | Slidegate, Blastgate  |
| 52    | VH550-B-2-4  | Actuator, Linear f/Blastgate, 120V/60Hz (U.S.)                |
| 53    | VH550-B-2-5  | Actuator, Linear f/Blastgate, 230V/50Hz (Overseas)            |
| 54    | 18-3 SJ      | Wire, 18-3 SJ, 50 ft long                                     |
| 55    | 543-M-11     | Plug, H320P   |
| 56    | VH550-B-2-6  | Capacitor, f/230V/50 Hz, Actuator (Overseas Only) (Not Shown) |

**WIRE COLOR CODE**

|        |               |
|--------|---------------|
| BLACK  | - 3 - PHASE   |
| RED    | - 120V HOT    |
| WHITE  | - 120V COMMON |
| YELLOW | - 24V HOT     |
| W/Y    | - 24V COMMON  |

# VH550 120V 60Hz WITH OUT BLASTGATE CONTROLS

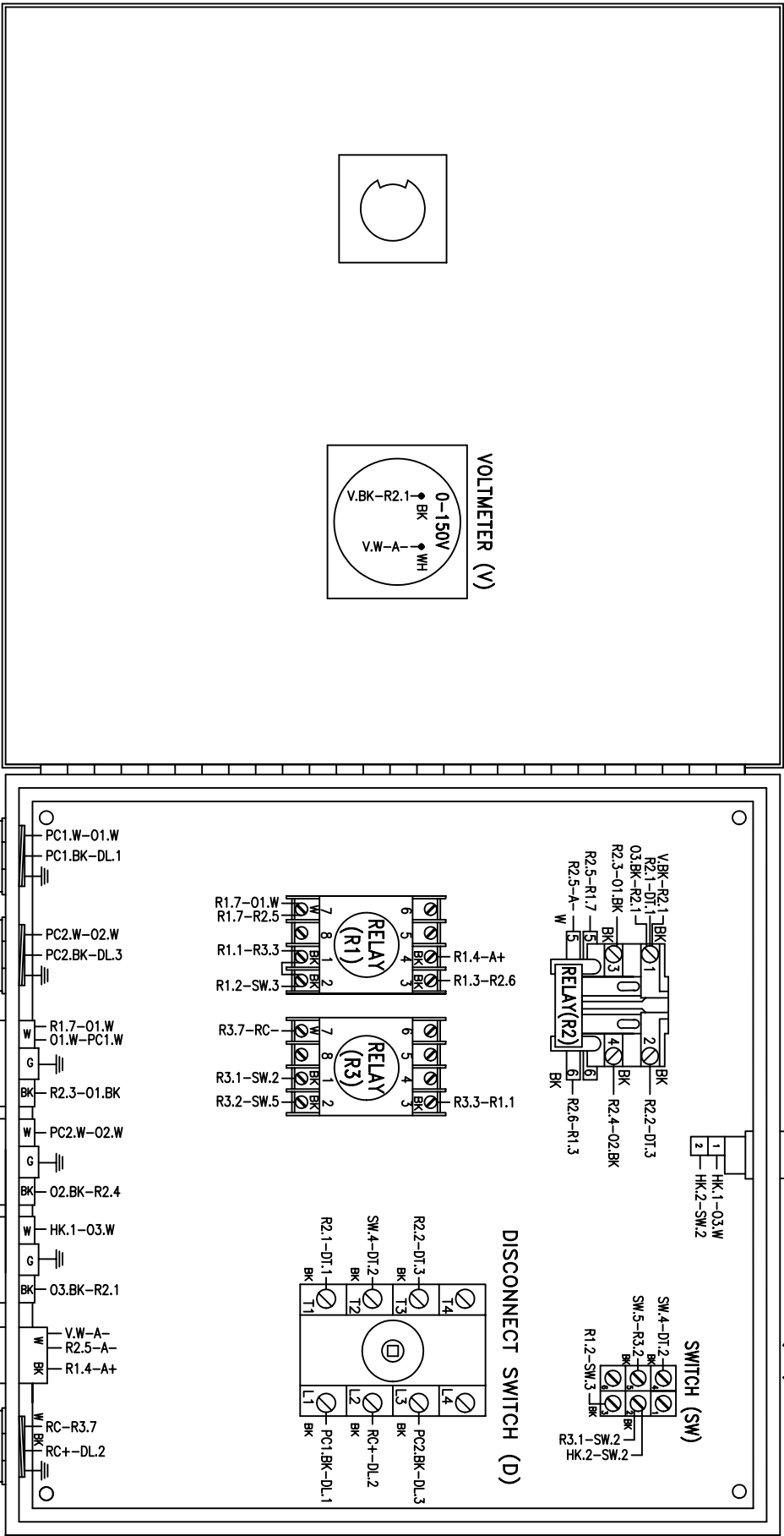

VOLT METER (V)

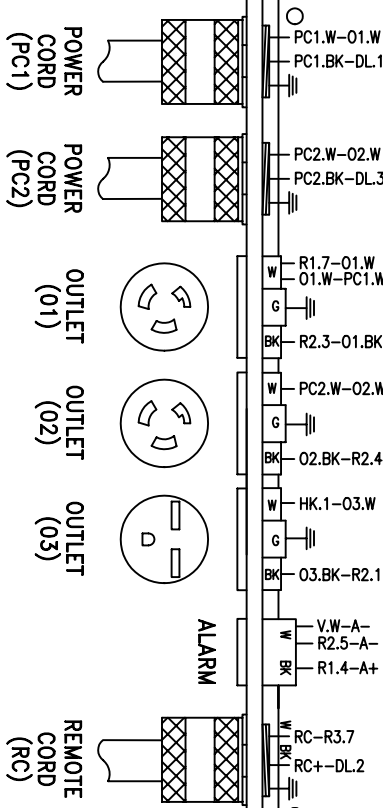

# VH550 Exploded Parts View

## VH550 WITHOUT BLASTGATE CONTROLS 120 V.A.C. 60 Hz. ELECTRICAL PARTS LIST

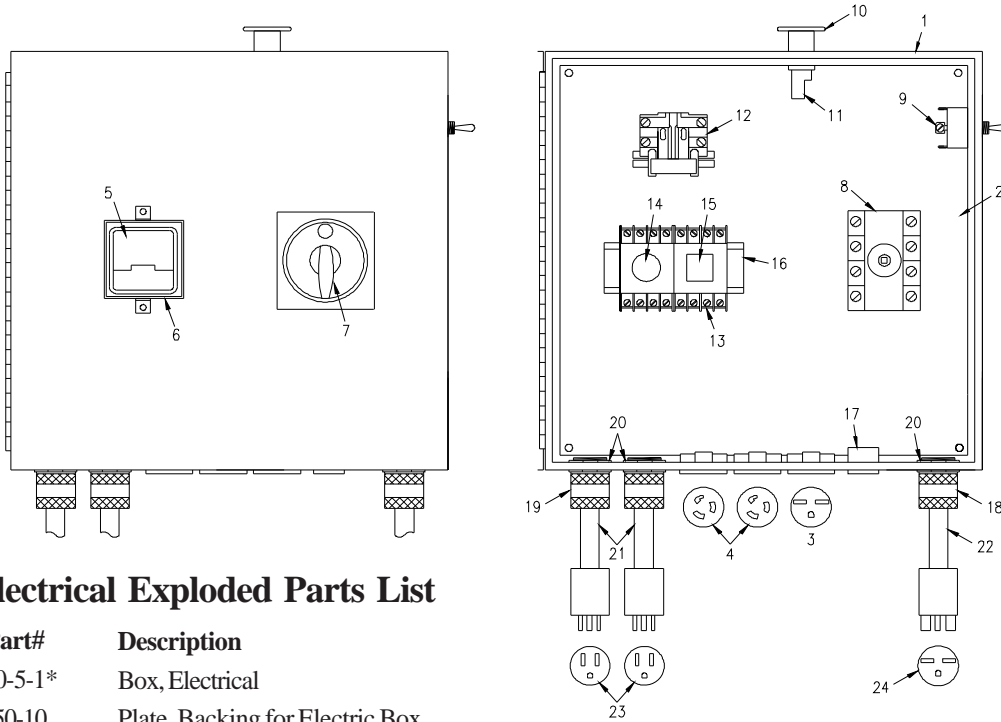

### VH550 Electrical Exploded Parts List

| Item# | Part#        | Description                                  |
|-------|--------------|--|
| 1     | 550-5-1*     | Box, Electrical                              |
| 2     | 550-10       | Plate, Backing for Electric Box              |
| 3     | 132-B        | Receptacle, NEMA #6-15R                      |
| 4     | 1542-A       | Receptacle, NEMA# L5-15R (2)                 |
| 5     | 1531-B       | Voltmeter, 0-300V                            |
| 6     | 550-3        | Guard, Voltmeter                             |
| 7     | 543-M-33-D*  | Operator Handle Assembly                     |
| 8     | 543-M-33-D   | Switch, Disconnect 40A #XA324BY              |
| 9     | 109066-9     | Switch, Toggle, (DPDT)                       |
| 10    | 508-2        | Kill Switch Button                           |
| 11    | 8075-1       | Kill Switch Contactor                        |
| 12    | 550-5-2      | Relay, 120V Heavy Duty                       |
| 13    | 543-M-41     | Socket, 8 Pin (2)                            |
| 14    | 543-M-39     | Relay for Pre-Alarm System, 24V              |
| 15    | 543-M-58     | Relay, 24V Tubular                           |
| 15    | 550-5-3      | Relay, 12VDC Cube                            |
| 16    | RM-DINRAIL-A | 1 3/8" Din Rail                              |
| 17    | 543-M-38     | Alarm for Pre-Alarm System, 24V              |
| 18    | 391N-A-2     | Connector, Cord, Liquid. Tite, 1/2" White    |
| 19    | 543-M-17     | Connector, Cord, Liquid. Tite, 1/2" Blue (2) |
| 20    | 391N-A-3     | Locknut, Steel, Conduit, 1/2" (3)            |
| 21    | 12-3 SJ      | Wire, 12-3 SJOW (20 ft. long) (2)            |
| 22    | 18-3 SJ      | Wire, 18-3 SJOW (20 ft. long)                |
| 23    | 127          | Plug, NEMA# 5-15P (2)                        |
| 24    | 126-B        | Plug, NEMA# 6-15P (goes on 24V only)         |

VH550 120V 60 Hz  
WITH VERTICAL AGITATOR & BLASTGATE CONTROLS (DOOR)

| WIRE COLOR CODE |               |
|-----------------|---------------|
| BLACK           | - 3 - PHASE   |
| RED             | - 120V HOT    |
| WHITE           | - 120V COMMON |
| YELLOW          | - 24V HOT     |
| W/Y             | - 24V COMMON  |

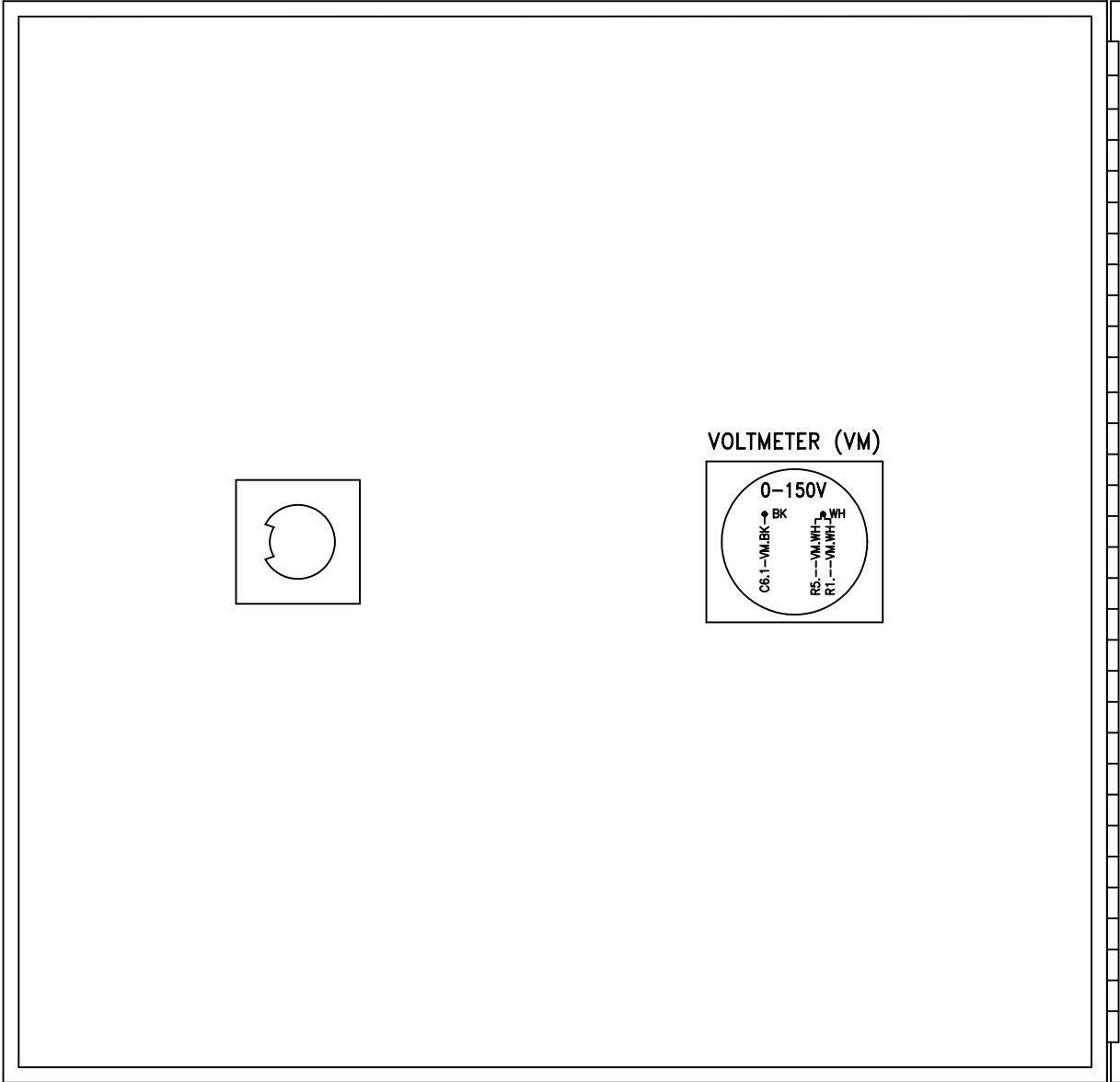

# VH550 120V 60Hz WITH VERTICAL AGITATOR & BLASTGATE CONTROLS (PANEL)

| WIRE COLOR CODE |               |
|-----------------|---------------|
| BLACK           | - 3 - PHASE   |
| RED             | - 120V HOT    |
| WHITE           | - 120V COMMON |
| YELLOW          | - 24V HOT     |
| W/Y             | - 24V COMMON  |

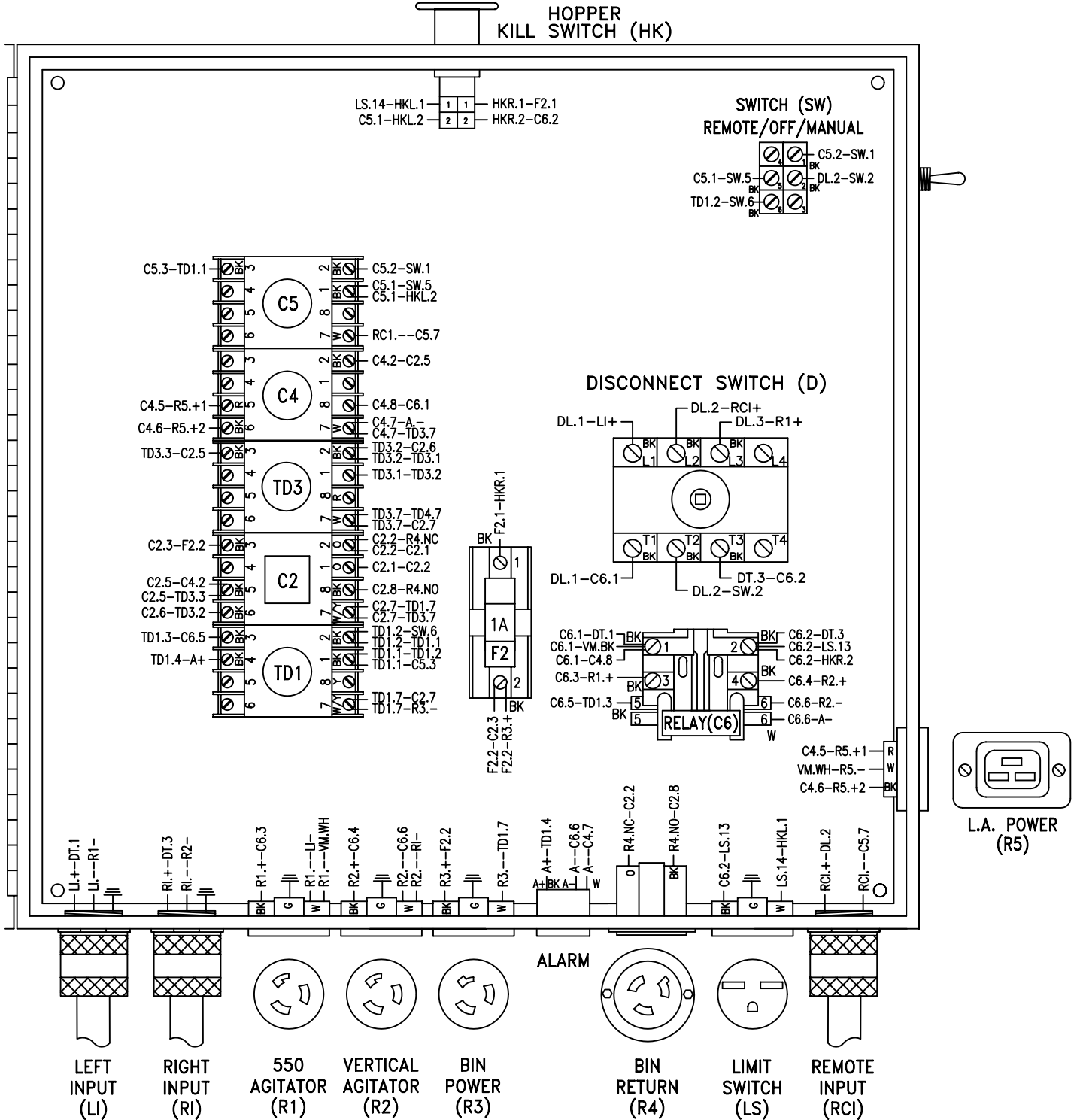

# VH550 Exploded Parts View

## VH550 W/VERTICAL AGITATOR & BLASTGATE CONTROLS 120 V.A.C. 60 Hz. ELECTRICAL PARTS LIST

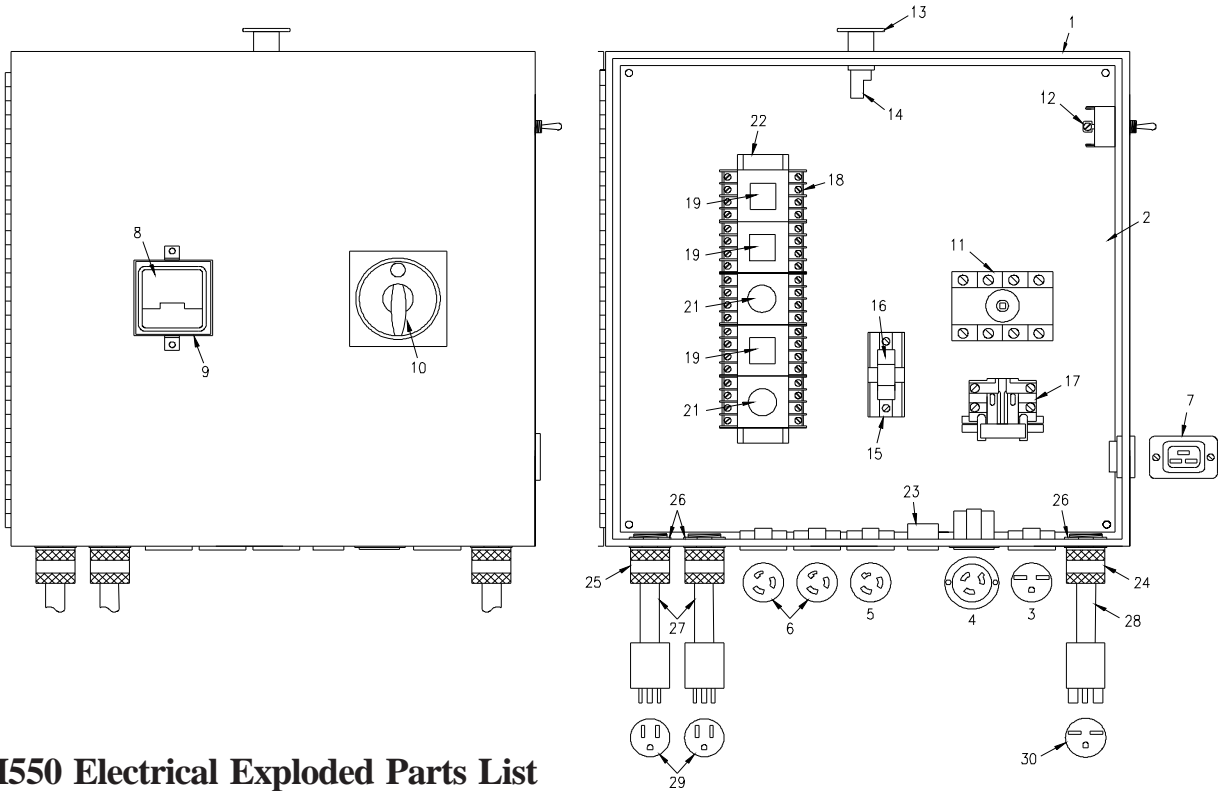

### VH550 Electrical Exploded Parts List

| Item# | Part#       | Description                         | Item# | Part#        | Description                                  |
|-------|-------------|-------------------------------------|-------|--------------|--|
| 1     | VH550-1-1   | Box, Electrical                     | 22    | RM-DINRAIL-A | 1 3/8" Din Rail                              |
| 2     | VH550-1-2   | Plate, Backing for Electric Box     | 23    | 550-5-4      | Alarm for Pre-Alarm System, 120V             |
| 3     | 132-B       | Receptacle, NEMA #6-15R             | 24    | 391N-A-2     | Connector, Cord, Liquid. Tite, 1/2" White    |
| 4     | 251080-28   | Receptacle, Flanged L6-15P          | 25    | 543-M-17     | Connector, Cord, Liquid. Tite, 1/2" Blue (2) |
| 5     | 1542-B      | Receptacle, NEMA# L6-15R            | 26    | 391N-A-3     | Locknut, Steel, Conduit, 1/2" (3)            |
| 6     | 1542-A      | Receptacle, NEMA# L5-15R (2)        | 27    | 12-3 SJ      | Wire, 12-3 SJOW (20 ft. long) (2)            |
| 7     | 543-M-6     | Receptacle, #H320R                  | 28    | 18-3 SJ      | Wire, 18-3 SJOW (20 ft. long)                |
| 8     | 1531-B      | Voltmeter, 0-300V                   | 29    | 127          | Plug, NEMA# 5-15P (2)                        |
| 9     | 550-3       | Guard, Voltmeter                    | 30    | 126-B        | Plug, NEMA# 6-15P (goes on 24V only)         |
| 10    | 543-M-33-D* | Operator Handle Assembly            |       |              |  |
| 11    | 543-M-33-D  | Switch, Disconnect 40A #XA324BY     |       |              |  |
| 12    | 109066-9    | Switch, Toggle,(DPDT)               |       |              |  |
| 13    | 508-2       | Kill Switch Button                  |       |              |  |
| 14    | 8075-1      | Kill Switch Contactor               |       |              |  |
| 15    | 543-M-10    | Fuse Holder, Single #9080FB1211     |       |              |  |
| 16    | 543-M-21    | Fuse, 1Amp Cartridge                |       |              |  |
| 17    | 550-5-2     | Relay, 120V Heavy Duty              |       |              |  |
| 18    | 543-M-41    | Socket, 8 Pin (5)                   |       |              |  |
| 19    | 543-M-51    | Cube Relay 120 Volt (3)             |       |              |  |
| 21    | 543-M-39    | Relay for Pre-Alarm System, 24V (2) |       |              |  |



230V 50Hz  
 VH550 WITH VERTICAL AGITATOR  
 & BLASTGATE CONTROLS (DOOR)

**WIRE COLOR CODE**

|        |               |
|--------|---------------|
| BLACK  | - 3 - PHASE   |
| RED    | - 120V HOT    |
| WHITE  | - 120V COMMON |
| YELLOW | - 24V HOT     |
| W/Y    | - 24V COMMON  |

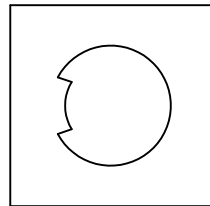

**VOLTMETER (VM)**

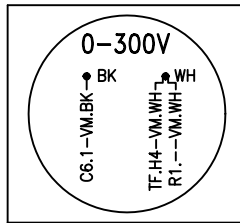

**MACHINE (DS1)  
 REMOTE/OFF/MANUAL**

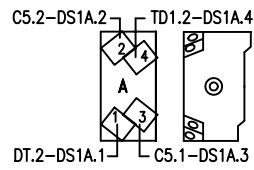

# 230V 50Hz VH550 WITH VERTICAL AGITATOR & BLASTGATE CONTROLS (PANEL)

## WIRE COLOR CODE

|        |               |
|--------|---------------|
| BLACK  | - 3 - PHASE   |
| RED    | - 120V HOT    |
| WHITE  | - 120V COMMON |
| YELLOW | - 24V HOT     |
| W/Y    | - 24V COMMON  |

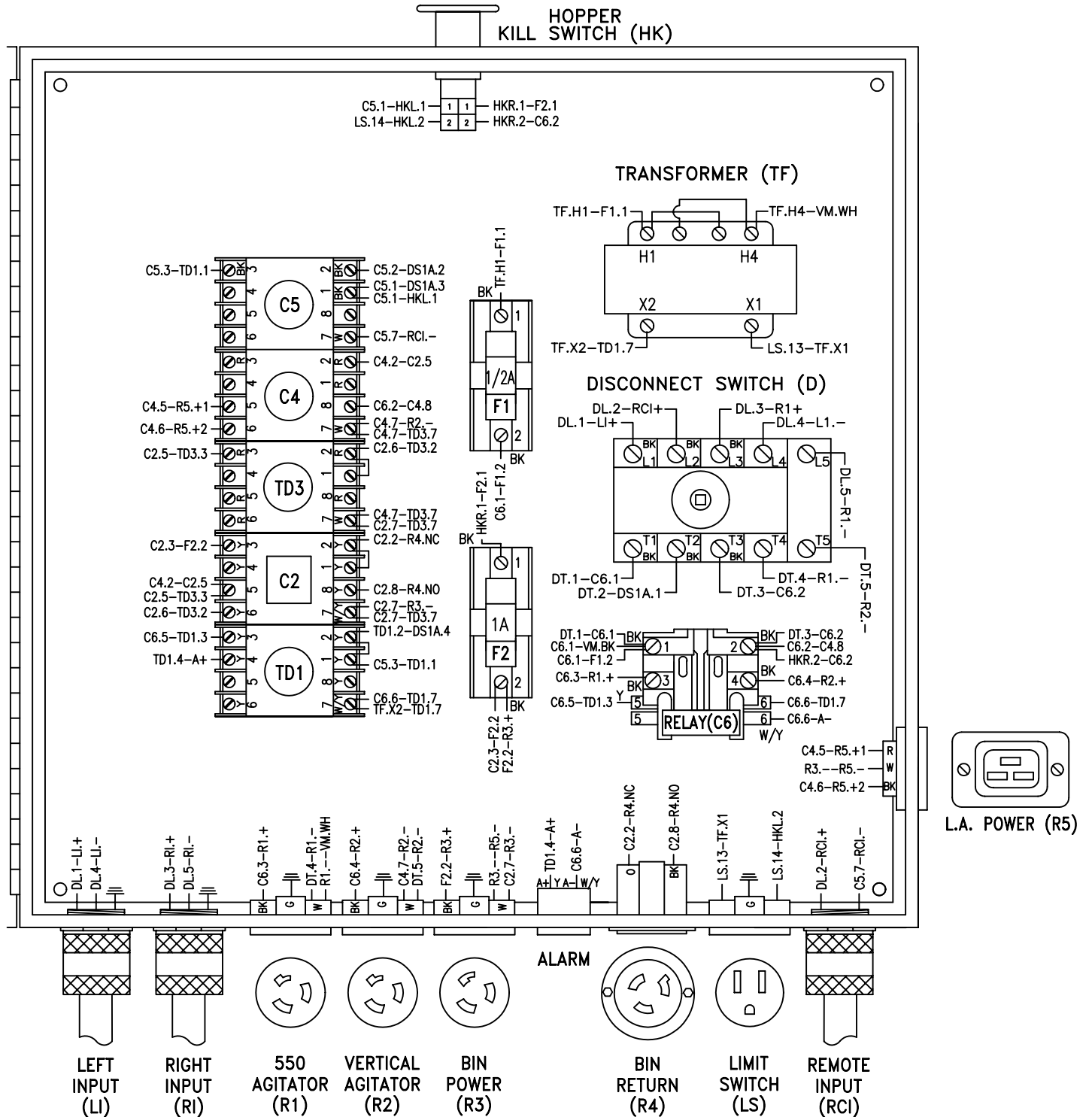

# VH550 Exploded Parts View

## VH550 W/VERTICAL AGITATOR & BLASTGATE CONTROLS 230 V.A.C. 50 Hz. ELECTRICAL PARTS LIST

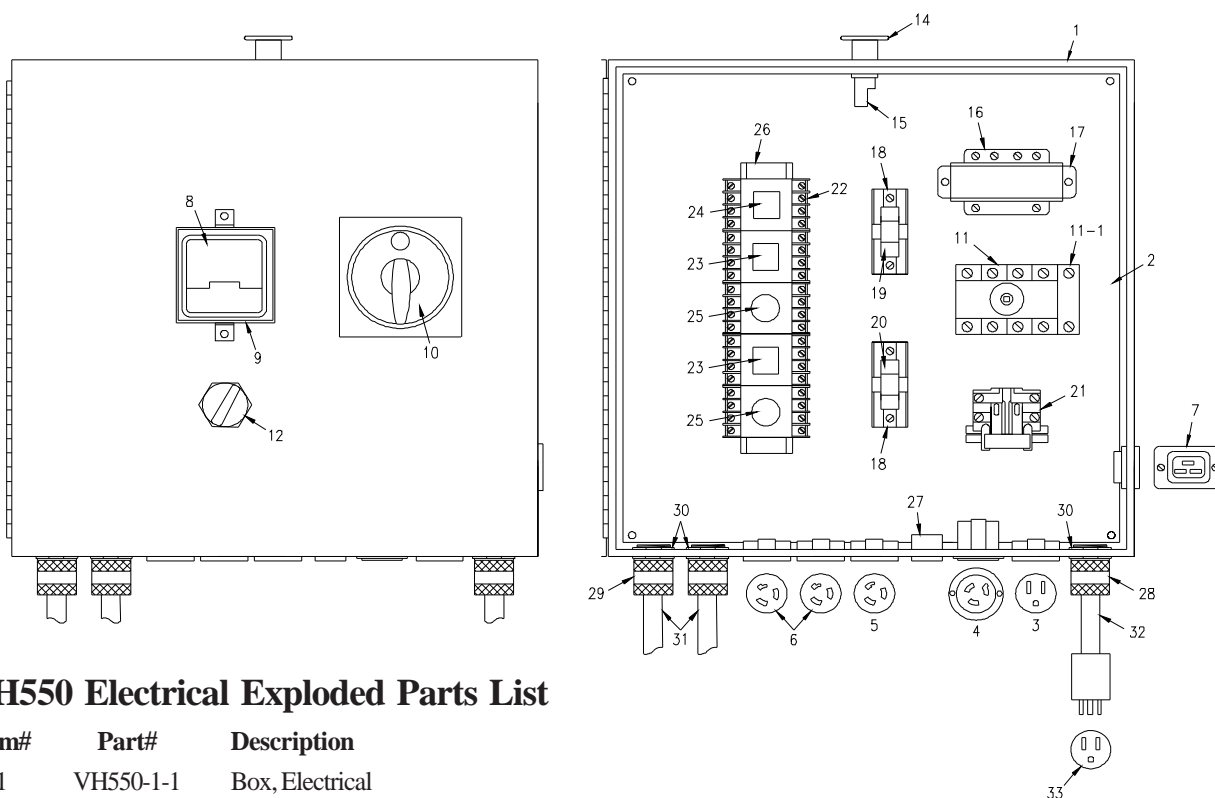

### VH550 Electrical Exploded Parts List

| Item# | Part#        | Description                         | Item# | Part#        | Description                                  |
|-------|--------------|-------------------------------------|-------|--------------|--|
| 1     | VH550-1-1    | Box, Electrical                     | 22    | 543-M-41     | Socket, 8 Pin (5)                            |
| 2     | VH550-1-2    | Plate, Backing for Electric Box     | 23    | 543-M-63     | Cube Relay 230 Volt (2)                      |
| 3     | 1544         | Receptacle, NEMA #5-15R             | 24    | 543-M-58     | Relay, 24V Tubular                           |
| 4     | 251080-28    | Receptacle, Flanged L6-15P          | 25    | 543-M-39     | Relay for Pre-Alarm System, 24V (2)          |
| 5     | 1542-A       | Receptacle, NEMA# L5-15R            | 26    | RM-DINRAIL-A | 1 3/8" Din Rail                              |
| 6     | 1542-B       | Receptacle, NEMA# L6-15R (2)        | 27    | 543-M-38     | Alarm for Pre-Alarm System, 24V              |
| 7     | 543-M-6      | Receptacle, #H320R                  | 28    | 391N-A-2     | Connector, Cord, Liquid. Tite, 1/2" White    |
| 8     | 1531-B       | Voltmeter, 0-300V                   | 29    | 543-M-17     | Connector, Cord, Liquid. Tite, 1/2" Blue (2) |
| 9     | 550-3        | Guard, Voltmeter                    | 30    | 391N-A-3     | Locknut, Steel, Conduit, 1/2" (3)            |
| 10    | 543-M-33-D*  | Operator Handle Assembly            | 31    | 12-3 SJ      | Wire, 12-3 SJOW (20 ft. long) (2)            |
| 11    | 543-M-33-D   | Switch, Disconnect 40A #XA324BY     | 32    | 18-3 SJ      | Wire, 18-3 SJOW (20 ft. long)                |
| 11-1  | 543-M-33-DTI | Add On Power Pole, No               | 33    | 127          | Plug, NEMA# 5-15P                            |
| 12    | 251080-3     | 3 Pos. Selector Switch              |       |              |  |
| 13    | 543-M-15     | Contact Block, KA-1 (not shown)     |       |              |  |
| 14    | 508-2        | Kill Switch Button                  |       |              |  |
| 15    | 8075-1       | Kill Switch Contactor               |       |              |  |
| 16    | 543-M-35     | Transformer, 2 Amp                  |       |              |  |
| 17    | 45464        | Cover Strap, 2 Amp Transformer      |       |              |  |
| 18    | 543-M-10     | Fuse Holder, Single #9080FB1211 (2) |       |              |  |
| 19    | 543-M-45     | Fuse, 1/2 Amp Cartridge             |       |              |  |
| 20    | 543-M-28     | Fuse, 2 Amp Cartridge               |       |              |  |
| 21    | 1529-B       | Relay, 24V Heavy Duty               |       |              |  |